

# UNIVERSITA' DEGLI STUDI DELLA CAMPANIA LUIGI VANVITELLI

RIPARTIZIONE    PROGRAMMAZIONE EDILIZIA APPALTI LAVORI

PROGETTO ESECUTIVO PER LA MESSA A NORMA DEGLI IMPIANTI TECNOLOGICI  
A SERVIZIO DEI RIUNITI ODONTOIATRICI



Tavola:

ARCH - 05

Scala:

Data:

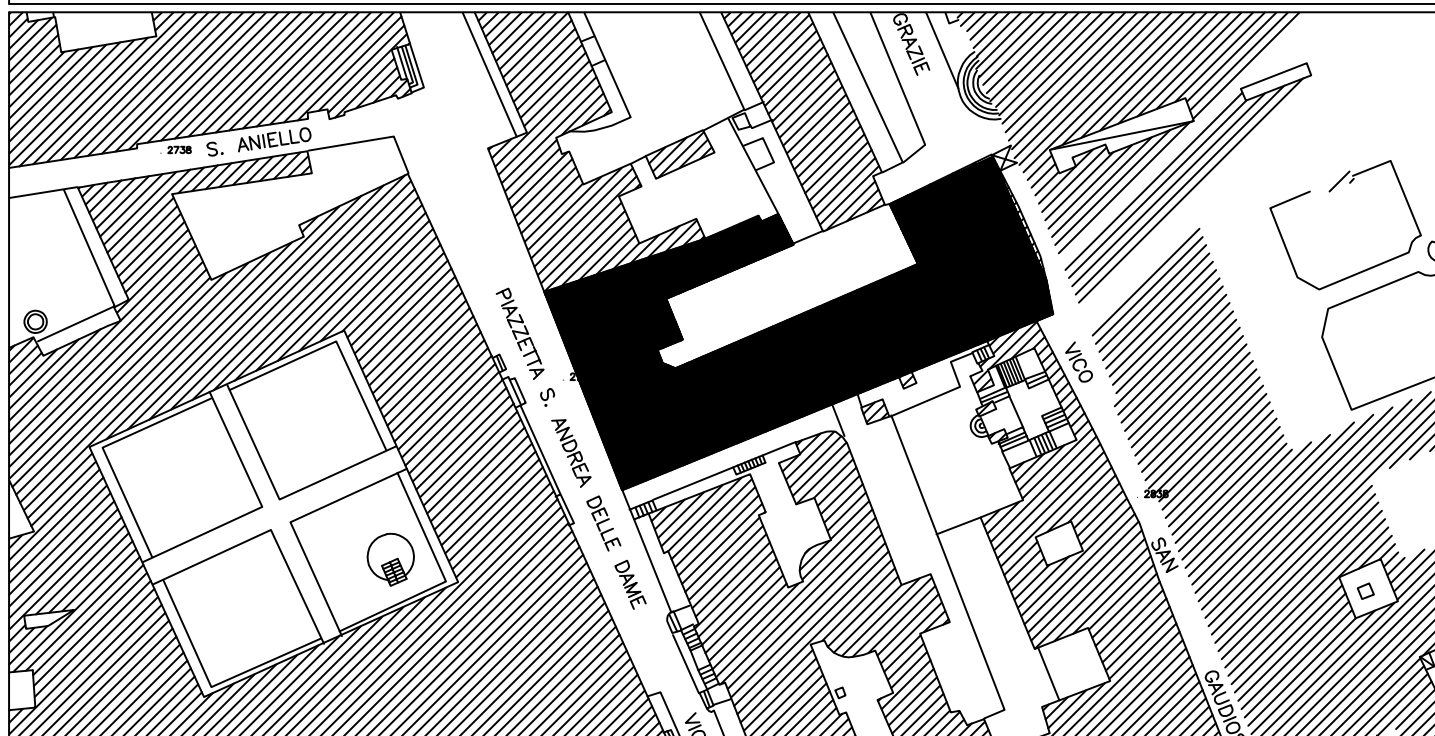
GENNAIO\_2020

Tipologia:

PROGETTO ARCHITETTONICO

Titolo:    SALA MACCHINA

GRUPPO DI LAVORO

- **ing. Giuliana Veneruso**  
PROGETTISTA IMPIANTI
- **arch. Anna Paola Carlino**  
PROGETTISTA ARCHITETTONICO
- **dott. Alessio Cibelli**  
COLLABORATORE ALLA PROGETTAZIONE
- **sig. Grazia Bianchino**  
ATTIVITA' DI SUPPORTO AL RUP

COORDINATORE PER LA SICUREZZA IN FASE DI PROGETTAZIONE

- **ing. Giuliana Veneruso**

RESPONSABILE DEL PROCEDIMENTO

- **ing. Amedeo Lepore**

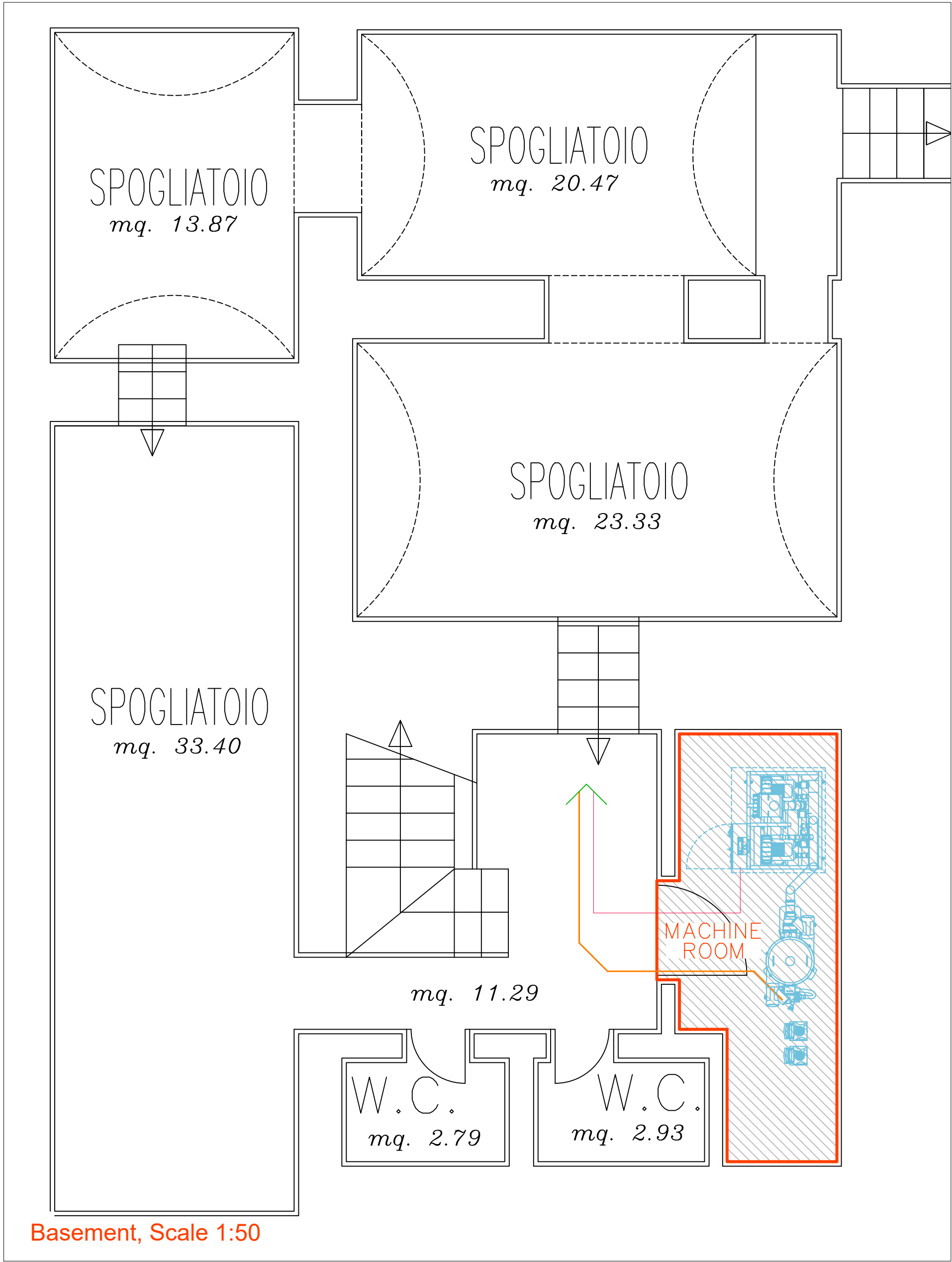

**LEGEND**  
Connections for Suction Unit V 6000, Duerr Dental

- 1 Main Power Supply for Suction Unit: 400V/3~; 50Hz; 5,6kW; 12,1A; free end: 3,0m
- 2 (not needed)
- 3 Control Line, 3x2,5mm<sup>2</sup> for Suction Unit
- 4 Exhaust Air led to the outside of the building; Ø 102mm (ID)
- 5 Air Conditioner / Room Ventilation
- 6 Suction Pipe Ø 102mm (ID)
- 7 Fresh Water for Rinsing; 3/4"
- 8 Waste Water Plumbing; Ø 45mm (ID); laid in 2% slope

**ATTENTION:**  
Above mentioned piping work (vacuum, air, exhaust, water, drain, disinfection) and wiring work (power supply, activation signal, data network) are the responsibility of others.

Environmental Requirements for Installation Room:  
Temperature ranges appliance in Operation:  
+10 to +40 Degrees Celsius.  
Relative humidity: max. 70%  
Room Ventilation or Air Condition is recommended!

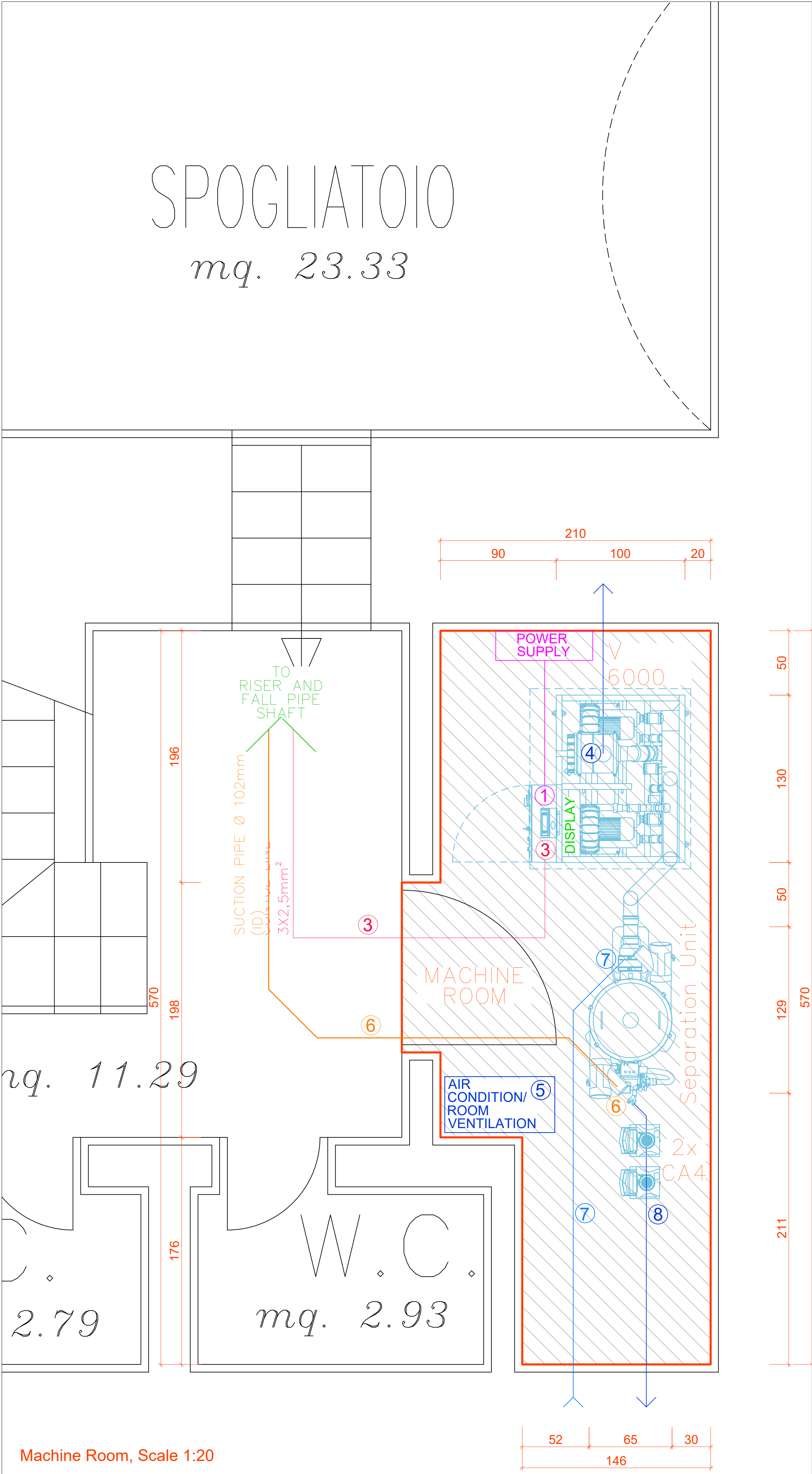

Vacuum Lines for Suction Machines, use only 45° elbows!  
Laying with 1% Slope!

Control Cable for Suction Machines.  
All control cables are 3 x 2,5 mm<sup>2</sup>.

**Vacuum pipe requirements:**

min. Vacuum = -250mbar  
Material: PVC-C, PVC-U, PE, PP  
ID = Inner Diameter

**Copper Pipe (CU), common sizes**

6 x 1		e.g. Cu 15 x 1 Ø 13mm
8 x 1		
10 x 1		
12 x 1		
15 x 1 (3/8")		
16 x 1		
18 x 1 (1/2")		
22 x 1 (3/4")		
28 x 1		
28 x 1,5 (1")		
35 x 1,5		
42 x 1,5 (1,5")		

**List of Documents**

No.	Document No.	Document
01	419018-Napoli_190805-VA	Pipe Scheme
02	419018-Napoli_Sala-Macchina_190805 -VA	Machine Room Set up Proposal

**Basics of Planning**

No.	Document No.	from	Document
01	1_odontoiatria con indicazioni.dwg	05.08.2019	Floor Plan, Duerr Dental SE
02	IMAGE.png	05.08.2019	Image, Duerr Dental SE
03	POLICLINICO-PHM-CAS-2019.dwg	05.08.2019	Floor Plan, Duerr Dental SE
04	Schacht.JPG	05.08.2019	Image, Duerr Dental SE

The manufacturers planning and installation instructions must be considered.

**MACHINE ROOM PLANNING**

All data are approximate values. We reserve the right to make technical alterations.  
Final drawings have to be made before starting with construction work.

**Customer Release Acknowledgement**

I agree to this preliminary as the basis for implementation planning. We have been informed of the importance of heeding all notes and requirements. Duerr Dental SE does not check and monitor compliance with on-site requirements and planning specifications, such as structural engineering, climate control, preparations for installation and electrical installations. We will contract the implementation and monitoring of on-site preparations for installation to qualified specialists.

Customer: \_\_\_\_\_

First Creation	Boagon CJ 05.08.2019		
Creation (♦) / Modification ( )	Edited	Sign.	Checked

Project:  
**Pianta Clinica Odontoiatrica Vanvitelli Napoli, Italy**

Part / Projection:  
**Basement**  
**Machine Room Set up Proposal for one V 6000 Suction Machine with Separation Unit and two CA 4 Amalgam Separators and one Display.**

Room height finished floor to  
Concrete Ceiling  
Suspended Ceiling

Scale: **1:50**  
**1:20**

Data File: 419018-Napoli\_Sala-Macchina\_190805 Sheet: 2/2 Format: DIN A1 DWGFILE